

# JCI-16GM 02&03 TYPE

엔코더 장착 가능 51Page 참고

- 사용 습도(Operating relative humidity) : 20% ~ 85%
- 사용 온도(Operating temperature) : -10°C ~ +60°C



## 제품도면 (Dimension)

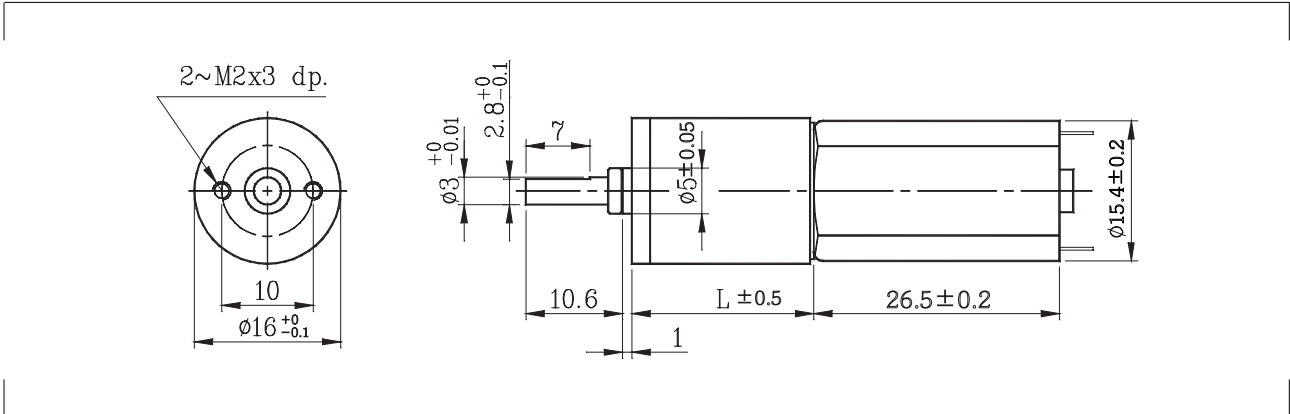

## 감속모터 사양 (Geared Motor Specification)

감속기 길이 (mm) Gear Head L	15.05				18.7				22.35				26				29.65			
감속비 Reduction ratio	1/4	1/14	1/19	1/29	1/62	1/72	1/84	1/104	1/128	1/157	1/231	1/316	1/370	1/455	1/561	1/690	1/1014	1/1621	1/1996	1/3027
02 Type 6v	정격토크(g-cm) Rated torque				26	72	99	150	270	320	370	460	560	699	855	1165	1360	1680	2050	2500
	정격 회전수(RPM) Rated speed				1460	455	333	219	105	90	77	63	51	41	28	20	17	14	11.5	9.2
03 Type 9v	정격토크(g-cm) Rated torque				24	68	94	140	255	300	350	430	530	660	800	1100	1250	1550	1900	2400
	정격 회전수(RPM) Rated speed				1450	450	330	217	104	90	76	62	50	41	28	20	17	14	11.5	9.2

## 모터부 사양 (Install motor specification)

### 02Type Motor (DC 6v)

• 정격 토크 Rated torque	7.4	(gf-cm)
• 정격 회전수 Rated speed	6,550	(RPM)
• 정격 전류 Rated current	160	(mA)
• 무부하 회전수 No load speed	8,000	(RPM)
• 무부하 전류 No load current	65	(mA)
• 정격 출력 Rated output	0.498	(W)

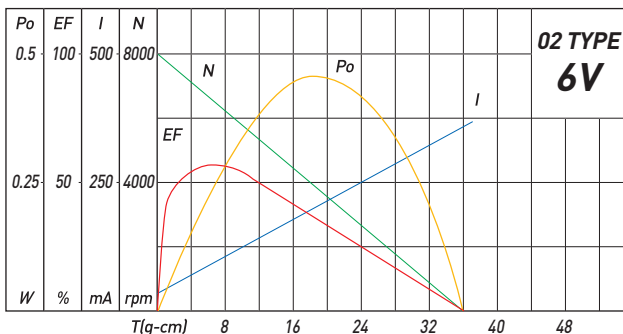

### 03Type Motor (DC 9v)

• 정격 토크 Rated torque	7.0	(gf-cm)
• 정격 회전수 Rated speed	6,500	(RPM)
• 정격 전류 Rated current	110	(mA)
• 무부하 회전수 No load speed	8,000	(RPM)
• 무부하 전류 No load current	50	(mA)
• 정격 출력 Rated output	0.473	(W)

